

Engine Start

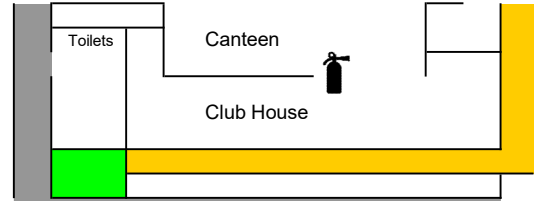
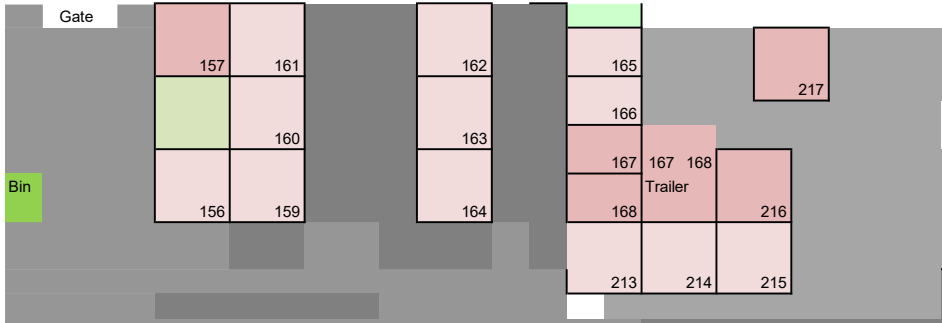

- 204
- 203
- 202
- 201
- 200
- 199
- 198
- 197
- 196
- 195
- 194
- 193
- 192
- 82m
- 83m
- Gate
- 72m
- 64m

No pegs to be used on bitumen road

	17	15	13	11	9	7	5	3	1	A	1
19	18	16	14	12	10	8	6	4	2	B	2

No pegs to be used on bitumen road way

63m	43	41	39	37	35	33	31	29	27	25	23	21	Runaway	3
67m	42	40	38	36	34	32	30	28	26	24	22	20		4

No pegs to be used on bitumen roadway

193	71	69	67	65	63	61	59	57	55	53	51	49	47	45	5
192	70	68	66	64	62	60	58	56	54	52	50	48	46	44	6

No pegs to be used on bitumen roadway

82m	103	101	99	97	95	93	91	89	87	85	83	81	79	77	75	73	7
83m	102	100	98	96	94	92	90	88	86	84	82	80	78	76	74	72	8

No pegs to be used on bitumen roadway

Car Park

72m	130	129	127	125	123	121	119	117	115	113	111	109	107	105	9
64m	128	126	124	122	120	118	116	114	112	110	108	106	104	10	

